

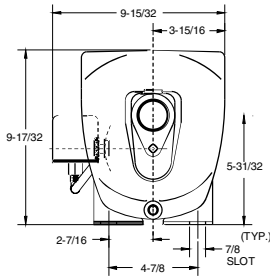

ProJet™ SN series – cast iron

Self-Priming Shallow Well Jet Pumps

OUTLINE DIMENSIONS



| Cat. No. | L | B |
|----------|------|-----|
| SNC | 18.7 | 7.1 |
| SND | 18.7 | 7.1 |
| SNE | 21.3 | 7.0 |
| SNF | 22.4 | 8.0 |

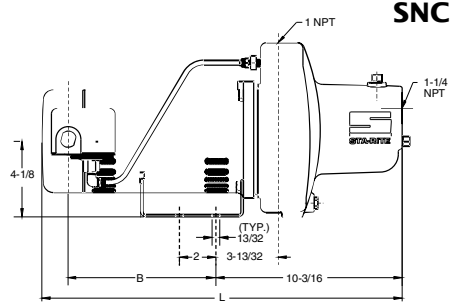
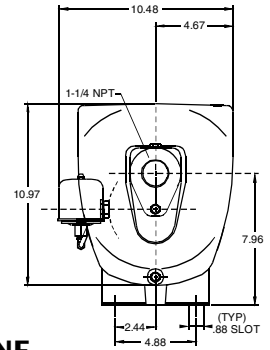

SNC and SND

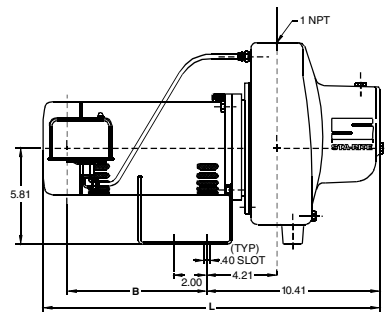

SNE and SNF

Dimensions (in inches) are for estimating purposes only.

PUMP PERFORMANCE

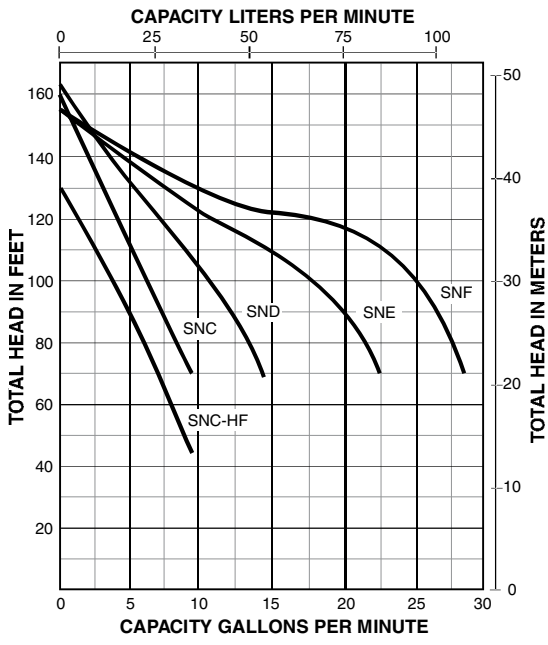

2.31 FT. OF HEAD = 1 PSI
1 FT. OF HEAD = .433 PSI

PUMP PERFORMANCE (Capacity in Gallons Per Minute)

| Catalog Number | HP | Disch. Pressure PSI | Dynamic Suction Lift | | | | | Shut-Off Pressure PSI |
|----------------|-------|------------------------|----------------------|------|------|------|------|--------------------------|
| | | | 5' | 10' | 15' | 20' | 25' | |
| SNC-HF25L | 1/2 | 20 | 13.7 | 12.3 | 10.6 | 8.8 | 6.3 | 56 |
| | | 30 | 11.8 | 10.6 | 9.3 | 8.2 | 6.2 | |
| | | 40 | 7.2 | 6.3 | 5.2 | 4.0 | 2.4 | |
| SNC | 1/2 | 30 | 9.7 | 8.3 | 7.4 | 5.9 | 4.3 | 70 |
| | | 40 | 7.9 | 7.2 | 6.4 | 5.6 | 4.1 | |
| | | 50 | 4.5 | 3.8 | 3.1 | 2.7 | 1.8 | |
| SND | 3/4 | 30 | 15.0 | 13.0 | 11.6 | 8.7 | 6.9 | 70 |
| | | 40 | 12.5 | 11.4 | 10.1 | 8.2 | 6.8 | |
| | | 50 | 8.0 | 6.8 | 6.1 | 4.8 | 3.5 | |
| SNE | 1 | 30 | 21.4 | 19.1 | 16.5 | 13.3 | 9.5 | 67 |
| | | 40 | 20.8 | 18.7 | 15.8 | 13.2 | 9.3 | |
| | | 50 | 13.5 | 11.6 | 10.1 | 7.4 | 2.4 | |
| SNF | 1-1/2 | 30 | 28.5 | 25.0 | 21.4 | 17.4 | 12.6 | 67 |
| | | 40 | 28.3 | 24.4 | 21.0 | 17.2 | 12.3 | |
| | | 50 | 21.5 | 18.3 | 10.9 | 3.1 | 1.6 | |

Pump will operate at all depths shown, with pressure switch set at 30-50 PSI.

Tested and rated in accordance with Water Systems Council Standards.

NOTE: Pumps installed with a PRO-Source™ tank require a 100 PSI relief valve. Pumps installed with a conventional tank require a 75 PSI relief valve. Relief valve must be capable of relieving entire flow of pump at relief pressure.